

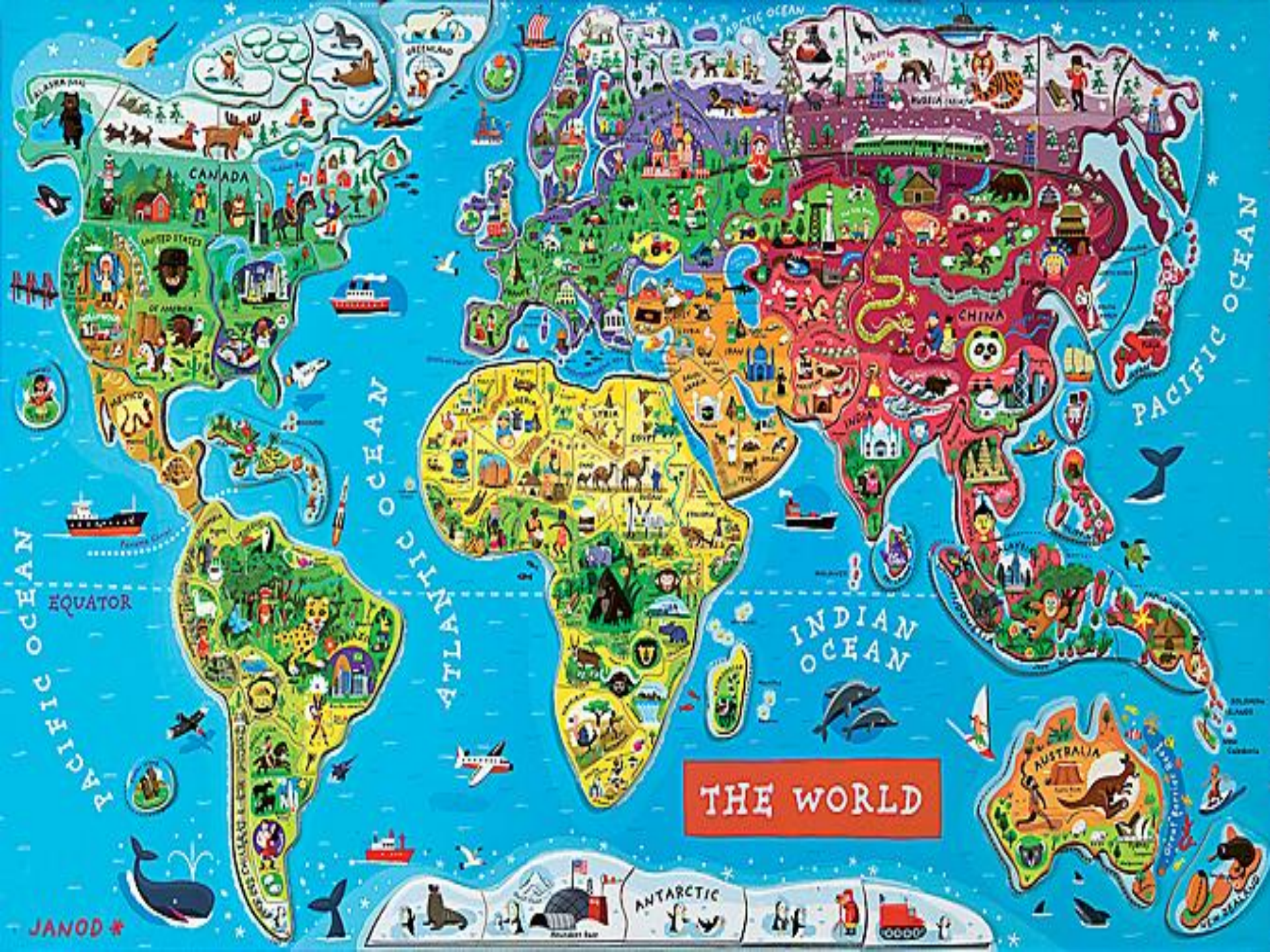

DROPS

DROPPED OBJECTS PREVENTION SCHEME



THE WORLD

- Eliminate injury to people and damage sustained to equipment due to dropped objects throughout the full supply chain;
- Ultimately to deliver a ‘**second-nature**’ dropped objects prevention strategy.



Dropped Object Consequences

- **Injuries and Fatalities**

Dropped Objects account for around 35% of all safety related incidents... **but account for over 60% of all HiPo's**

- **Equipment and Environmental Damage**

Dropped Objects cause damage to plant and equipment... Including seabed.

- **Reputational Damage**

Not good for business...



1. Hands
2. Feet
3. Arms
4. Legs
5. Torso
6. Abdomen
7. Head

Hazard Identification and Risk Assessment

■ Opportunities

- Impart your EXPERIENCE and KNOWLEDGE
- PRE-TASK PROMPTS, JOB PLAN / JSA, PTW
- Tool Box Talks, TOFS, Stop Work Authority
- DROPS Calculator
- Third Party Support
- Post Task ('DROPS Sweep', incomplete tasks etc)



DROPS

Dropped Object Awareness

Understanding Dropped Object Consequences

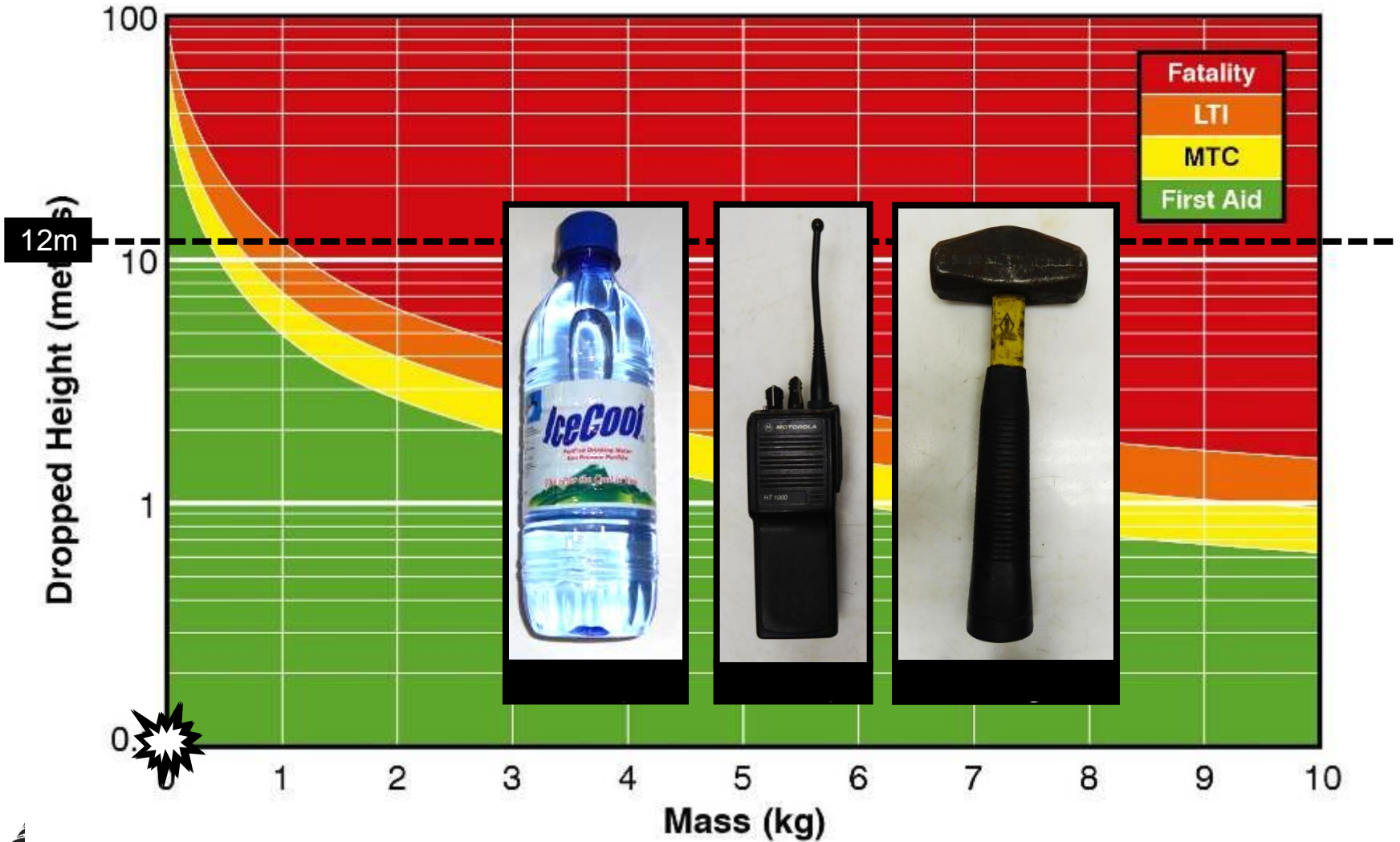

Hazard Identification and Risk Assessment

■ Standard Hierarchy of Controls

- ELIMINATE
- SUBSTITUTE
- CONTROL
 - Engineered Methods
 - Procedures
 - PPE

**PREVENTIVE
CONTROLS vs
MITIGATING
MEASURES**

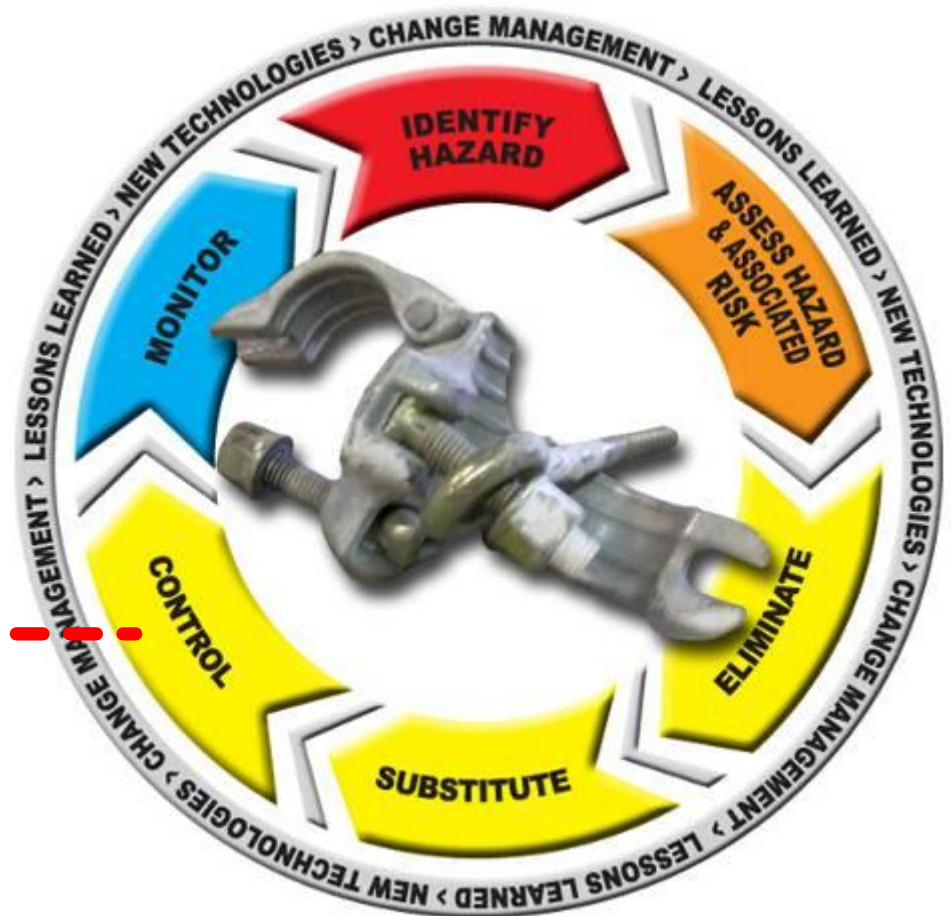

DROPS

Dropped Object Awareness

Controlling Dropped Object Hazards

- **DROPS CONTROLS** (preventive and mitigating)

- **Primary Fixings and Secondary Retention**
- **Preventive Maintenance System**
- **Independent Dropped Object Surveys**
- **Planned Dropped Object Visual Inspections**
- **Pre-Task Risk Assessments and Checks**
- **Management of Change**
- **Stop the Job, Communication and Drops Vigilance**
- **Safety Securing**
- **Restricted Access Areas**

**APPLICABLE TO
ALL AREAS IN ALL
ASSETS AND
FACILITIES ON A
RISK BASED
APPROACH**

- **Work at Height and Lifting Requirements**

- **Tools and Equipment Aloft Log Book**
- **Securing Tools and Equipment at Height**
- **Temporary Barricades**
- **PA / Audible Warnings and Standby Persons**

**APPLICABLE TO
ALL WORK AT
HEIGHT ACTIVITIES
IN ALL ASSETS AND
FACILITIES**



Restricted Access Areas

- Cone of Exposure
- Dynamic Tasks
- Communications

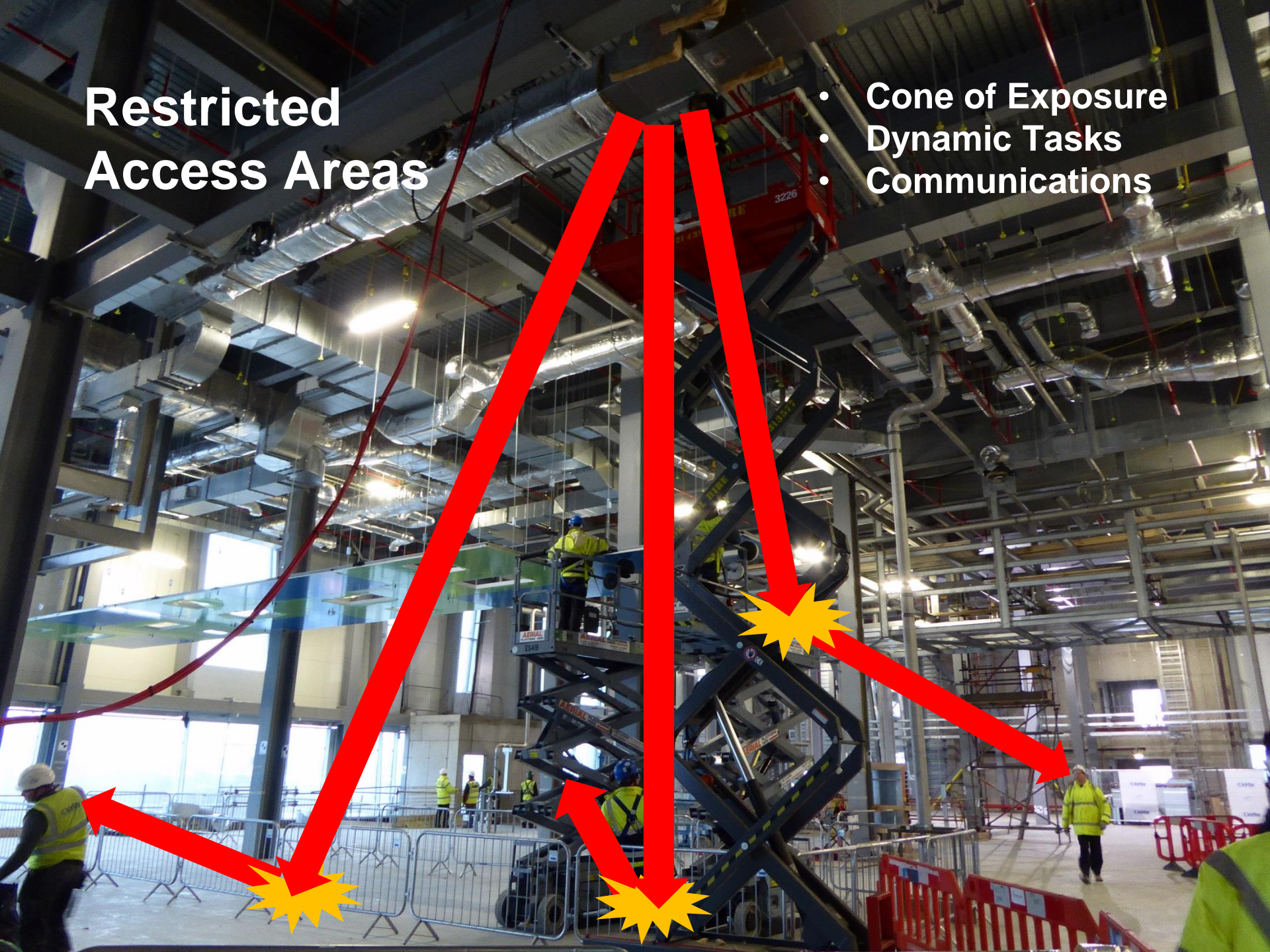

Zone Management Challenges

- No 'Safe' Zone
- Colour Coding Ambiguity
- Red Zone / DROP Zone / Restricted Access Area / No-Go Zone
- Drill Floor Application
- Dynamic Approach

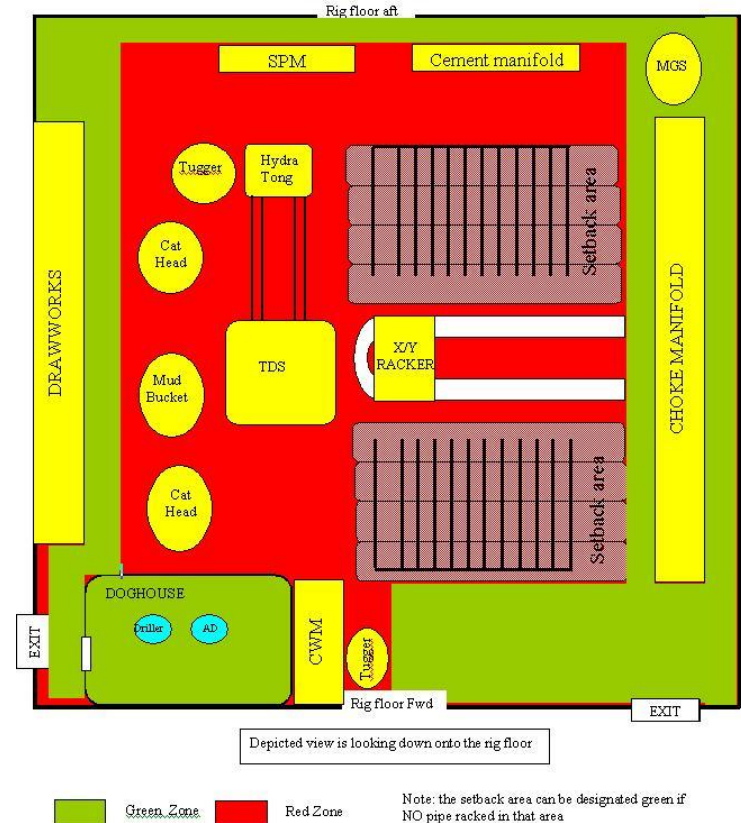

DROPS Red Zone Principles

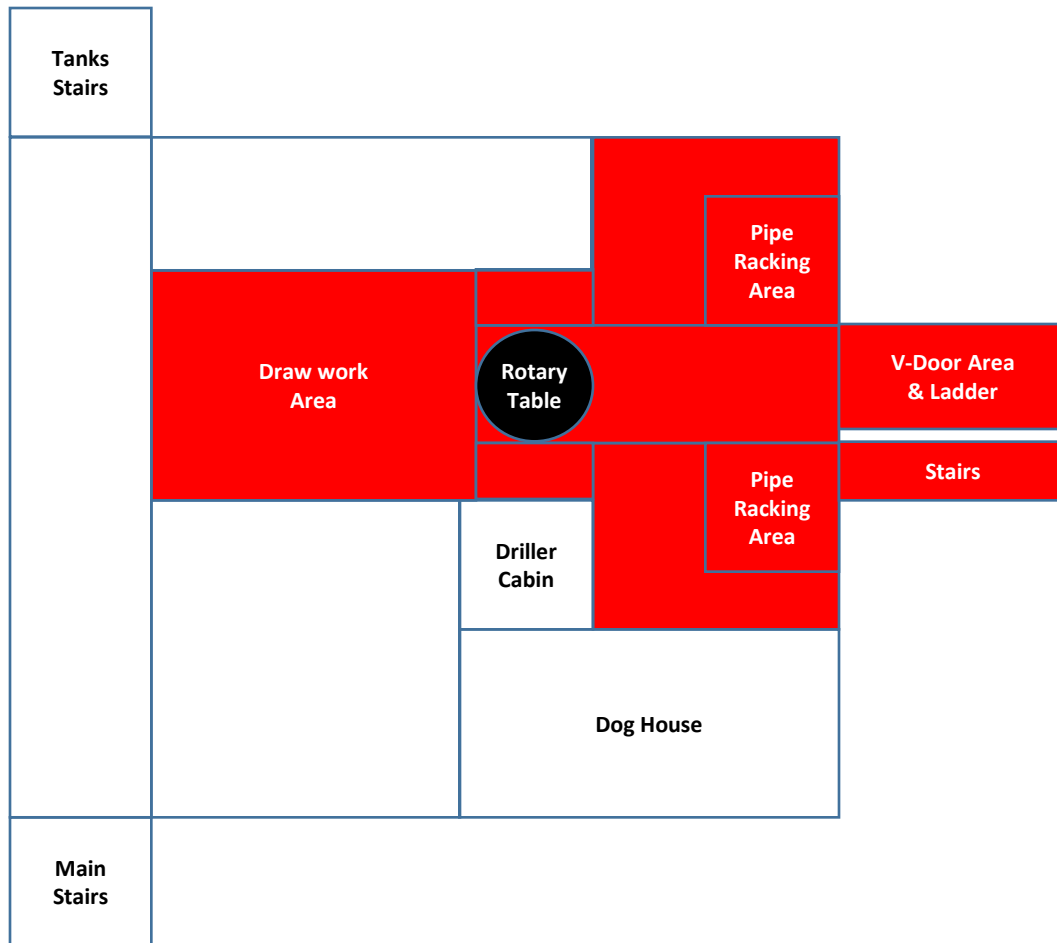

- Strictly controlled access, approval required from Area Authority
- Only persons required for the task
- Minimum exposure, identify step back areas
- Personnel aware of all moving machinery and other hazards
- Appropriate plan in place for specific activities
- No personnel may join a task without a TOFS.



Collating 'Best in Class' DROPS Guidance

DROPS Global

Regional Chapters

STEERING COMMITTEE

WORK GROUPS

- Chaired by Operator(s)
- Representation from Major Drilling Contractors and Service Partners
- Industry Bodies and Specialists

- Quarterly Meetings
- Communications
- Local Events
- Topics and Projects

THE WORLD

WHERE CAN DROPS INFLUENCE ME?

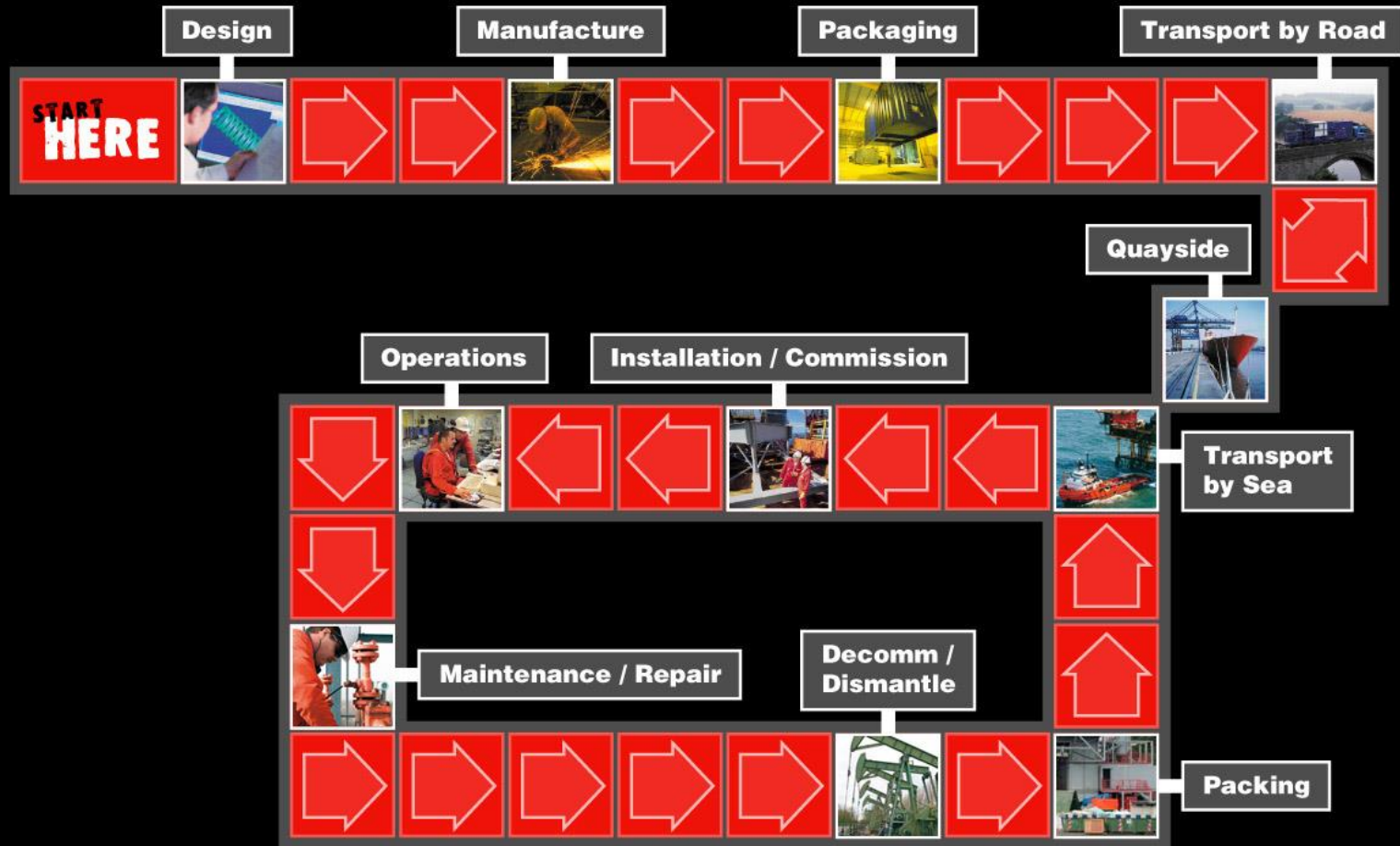

ACTIVE AND ENGAGING LEADERSHIP

- **Continually raise awareness of dropped object hazards and DROPS throughout Supply Chain**
- **Ensure all tasks follow the fundamentals of Task Risk Assessment and Hierarchy of Control**
- **Review task specific assessments (*and procedures*) to ensure dropped object hazards are identified and eliminated or controlled**
- **Enforce basic safe working practices**
- **Keep DROPS at the forefront of the Business.**



DROPPED OBJECTS

STILL HARMING
STILL KILLING



Thank You

DROPS

DROPPED OBJECTS PREVENTION SCHEME

www.dropsonline.org